

CAMPLE—LINE

YELENA POPOVA / MADE GROUND

01.10 - 11.12.22

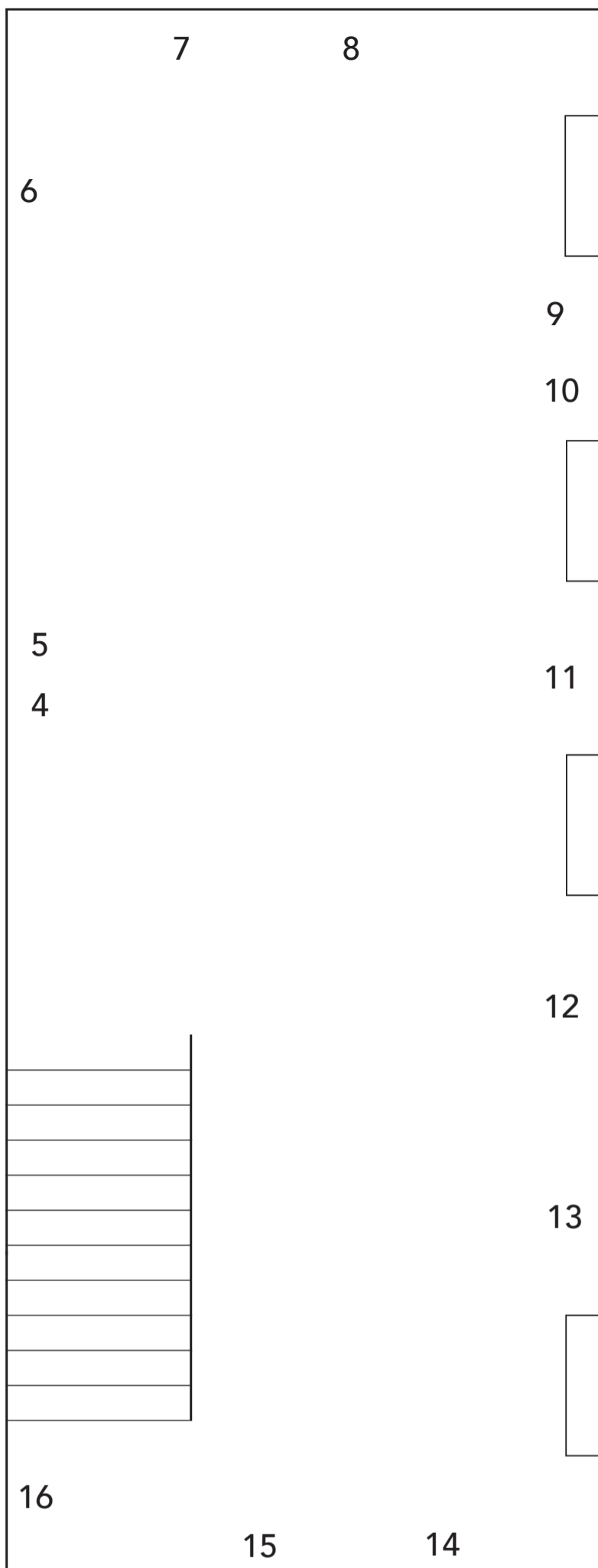

1 *Entrance space:*
Spruce, 2022
cotton cord knitting
109 x 161 x 2 cm

2 Ornamental stone sculptures,
Photographs taken by the artist
at Drumlanrig Castle, Thornhill

3 *Downstairs space:*
Hunting Scene with a Ray Cat,
2022
Jacquard woven throw
Limited edition of 28
220 x 160 cm

4 **Scaur Bridge**
Post Petrochemical paintings
series, 2022
earth pigment on cotton canvas
80 x 60.5 cm

5 **Thornhill. 55.242663, -3.773200**
Post Petrochemical paintings
series, 2022
80 x 60 cm

6 **Penpont**
Post Petrochemical paintings
series, 2022
earth pigment on cotton canvas
56 x 45.5 cm

7 **Scaur, 55.226374, -3.811730**
Post Petrochemical paintings series,
2022
earth pigment on cotton canvas
137 x 106 cm

8 **Sun trap, 55.226374, -3.811730**
Post Petrochemical paintings series,
2022
earth pigment on cotton canvas
28 cm diameter

9 **Sunshine Corner I**
Post Petrochemical paintings series,
2022
earth pigment on cotton canvas
28 cm diameter

10 **Sunshine Corner II**
Post Petrochemical paintings series,
2022
earth pigment on cotton canvas
28 cm diameter

11 **Cample 1**
Post Petrochemical paintings series, 2022
earth pigment on cotton
43 x 33 cm

12 **Nith**
Post Petrochemical paintings series, 2022
earth pigment on Irish Linen
81 x 66 cm

13 **Cample 2**
Post Petrochemical paintings series,
2022
earth pigment on cotton
43 x 33 cm

14 **Kings Quarry**
Post Petrochemical paintings series, 2022
earth pigment on vintage Irish Linen and
found brick
117 x 96 cm

15 **Drumlanrig**
Post Petrochemical paintings series, 2022
earth pigment on Irish Linen
90 x 70 cm

16 **Thornhill 55.285234, -3.770300**
Post Petrochemical paintings series, 2022
earth pigment on cotton
60.5 x 50.5 cm