

CAMPLE—LINE

KIRA FREIJE / RIVER BY NIGHT

25.03 - 10.6.23

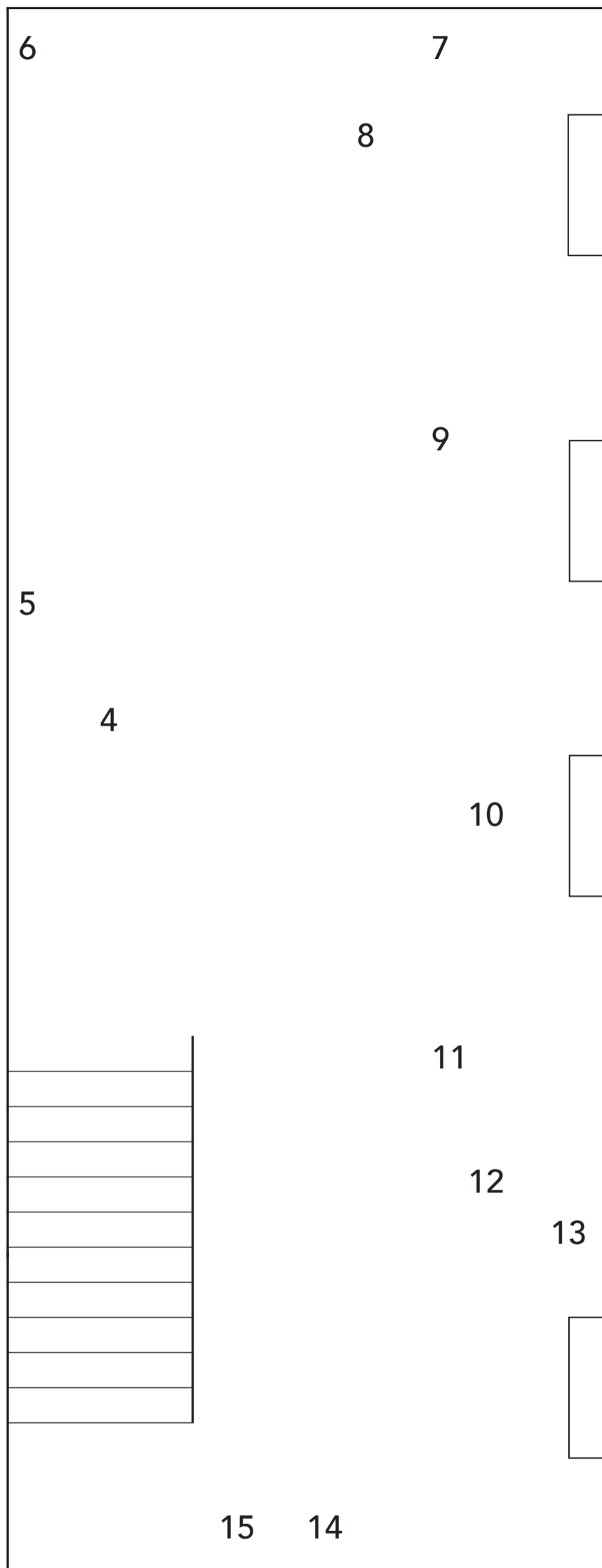

Downstairs space

From left of entrance, clockwise:

- 1 **Carousel**, 2022
stainless steel, mouth-blown glass, coiled wire, lightbulb
- 2 **ripples congregate on the surface at dusk**, 2023 , stainless steel, mouth blown glass, LED light
- 3 **Passages**, 2019
stainless steel, mouth blown glass, LED light

Upstairs space:

- 4 **Moving towards the calm one, whose arms open, the breadth of happiness in measurable form**, 2021,
stainless steel, cast aluminium
- 5 **distant sounds of latches closing, echo as warmth leaves slatted doors**, 2023
stainless steel, mouth blown glass, LED light
- 6 **bleached haze scrapes rooftops, rising morning**, 2023
stainless steel, mouth blown glass, LED light
- 7 **Weary travellers gather, in unison eyes scour the dusty ground**, 2021
stainless steel, cast aluminium, mouth blown glass, LED lamp
- 8 **fireworks**, 2022
stainless steel, cast aluminium, wool felt
- 9 **permanence of a sacred tongue**, 2022 stainless steel, cast aluminium, cotton
- 10 **Autumn dusk**, 2022
stainless steel, mouth-blown glass, coiled wire, lightbulb
- 11 **river by night**, 2022
stainless steel, mouth-blown glass, lightbulb
- 12 **Butterfly**, 2022
stainless steel, steel, glass roundels, lightbulbs
- 13 **Awakes to ask did they decide**, 2019
stainless steel, mouth blown glass, LED light
- 14 **Recognition of the world behind at nightfall**, 2022
Stainless steel, cast aluminium
- 15 **memory of the voyager**, 2022
stainless steel, beach weathered glass, coiled wire, lightbulb